

1 Roof Framing Plan

1/8" = 1'-0"

1. ALL EXISTING CONDITIONS AND DIMENSIONS SHOWN AS ± SHALL BE CONSIDERED APPROXIMATE AND SHALL BE FIELD VERIFIED BY CONTRACTOR PRIOR TO BEGINNING CONSTRUCTION.
2. FIELD SET LOCATION OF EDGE OF ROOF TO MATCH EXISTING.

3 Typical Lintel in Existing Block

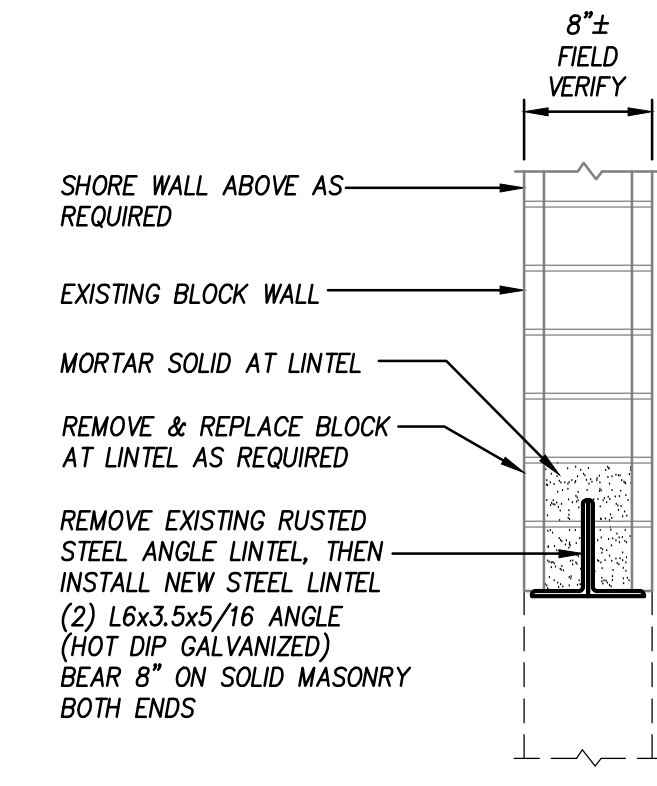

1" = 1'-0"

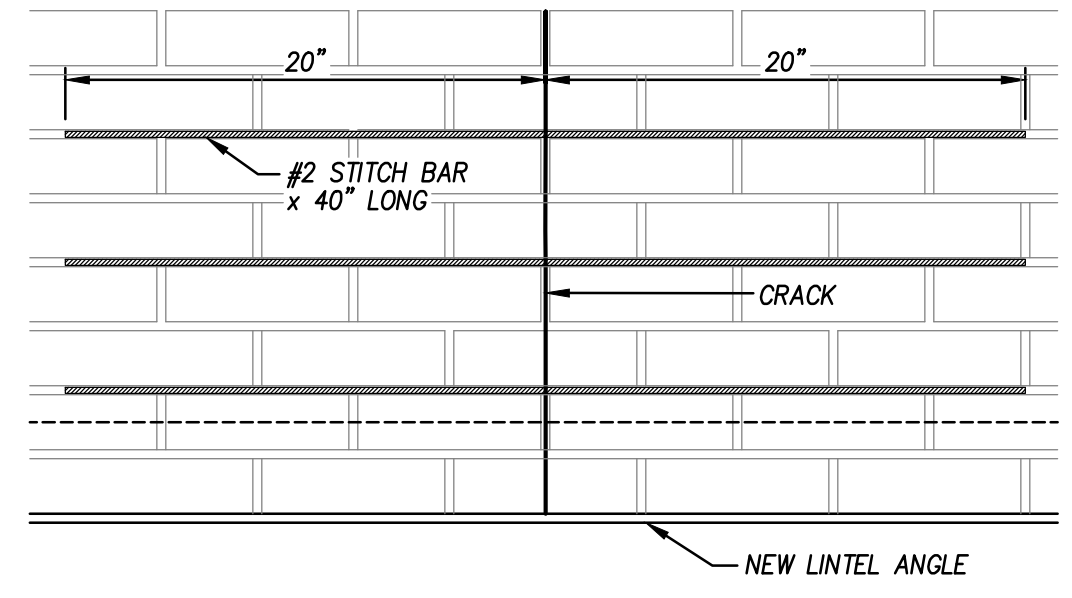

SUGGESTED CRACK REPAIR:

1. GRIND OUT HORIZONTAL JOINT MINIMUM 20 INCHES EACH SIDE OF VERTICAL CRACK TO A DEPTH OF 1 1/2 INCHES.
2. CLEAN JOINT OUT WITH WATER AND STIFF BRISTLE OR WIRE BRUSH.
3. INSTALL BEAD OF MORTAR AT THE BASE OF THE CRACK BY USING TUCK-POINTING SQUEEZE BAG WITH TAPERED TIP.
4. INSERT #2 REINFORCING BAR x 40 INCHES LONG INTO BASE OF JOINT.
5. APPLY FINAL BEAD OF MORTAR OVER THE REINFORCING BAR.
6. TOOL JOINT TO MATCH ADJACENT BLOCK JOINTS WHEN THUMB PRINT HARD.
7. INSTALL STITCH BAR EVERY 2ND BLOCK COURSE (~8 INCHES ON CENTER).
8. TUCK POINT REMAINING CRACK BETWEEN STITCH BARS.

2 Typical Stitch Repair

1 1/2" = 1'-0"

Drawing Status: **For Permit & Construction**

Rev. No.	Date	Description

WSE WAYLAND
 STRUCTURAL ENGINEERING
 2801 SW 81st Street Gainesville, FL 32608
 Phone: 352-370-1210
 Email: info@wsefl.com
 Florida COE: #8236

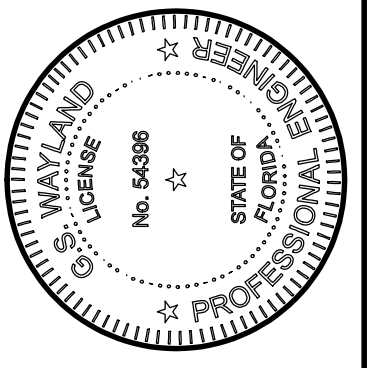

Client: **FL National Guard - Dept. of Military Affairs**
Starks, FL
 Project Name: **Cooper Hall Renovation at Camp Blanding Joint Training Center (CBJTC)**
 Drawing Name: **Roof Framing Plan & Details**

Drawn by: **GS WAYLAND**
 Date: **NOVEMBER 6, 2019**
 WSE Project No.: **19123**

Drawing No. **S3.01**

MAS-W302

CONX 003